

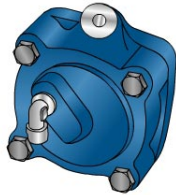

PZB®

32282

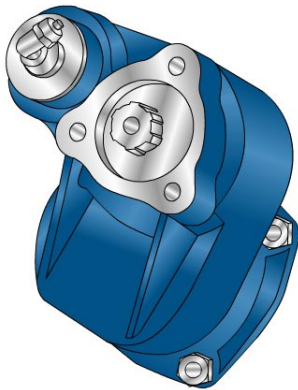

32282 **XX** **Y** **ZZZ**

Outlet version
Available option
Control option
Model

	Output 1	
Torque (Nm)	250	
Inf. ratio	1	
Number of axles	2	

Number of teeth	20
Module	2,54
Replace	
Replaced by	

10/10/2006

Command type

- | | | |
|---|---|---|
| <input type="checkbox"/> Mechanical with lever remote control (TC) | <input type="checkbox"/> Hydraulic control | <input type="checkbox"/> Pneumatic |
| <input type="checkbox"/> Ready for electric solenoid control | <input type="checkbox"/> Depressure control | <input type="checkbox"/> Constantly engaged |
| <input type="checkbox"/> Mechanical with PUSH-BUTTON remote control | <input type="checkbox"/> Electric control KES 5 | <input type="checkbox"/> Ready for detached control |

