



SPLIT-SHAFT UNIT 2000 KGM

3.2.90.5.

3000 KGM

3.2.90.6.



- ✓ Inserted in the driveshaft between gearbox and rear axle.
- ✓ PTO shaft torque capability: 60 kgm max at 3000 rpm.
- ✓ Two - one to front, one to rear - independently shiftable PTO's for hydraulic pumps or prop-shaft drive.
- ✓ Auxiliary power available with the vehicle in motion.
- ✓ Drive connection to rear axle independent on PTO operation.
- ✓ Provision for electronic tachograph (Mannesmann VDO type):
code 0.99.00.740.00 (dynamic with faston-type joint),
code 0.99.00.741.00 (static with faston-type joint),
code 0.99.00.742.00 (static with plug type joint).
- ✓ Max throughput rpm: **2.200 rpm.**

TORQUE RATING THROUGH THE MAIN DRIVE SHAFT:

2000 kgm for 3.2.90.5

3000 kgm for 3.2.90.6

AVAILABLE PTO OUTPUT RATIOS: 1,562:1

ROTATION: engine

WEIGHT 3.2.90.5: kg. 114 (without flanges)

3.2.90.6: kg. 116 (without flanges)

3.2.90.X.00000

BASIC SERIAL NUMBER _____

TORQUE RATING THROUGH THE MAIN DRIVE SHAFT

5 = 2000 KGM

6 = 3000 KGM

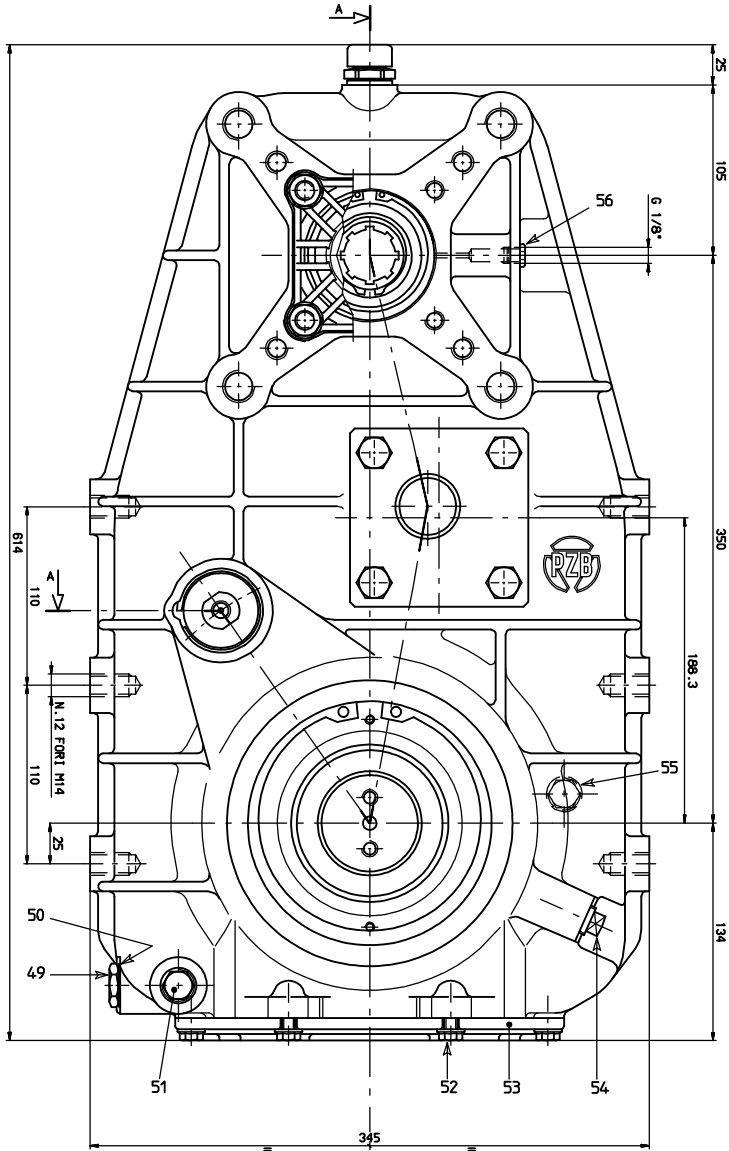

REAR VIEW

VERSION 3.2.90.5.

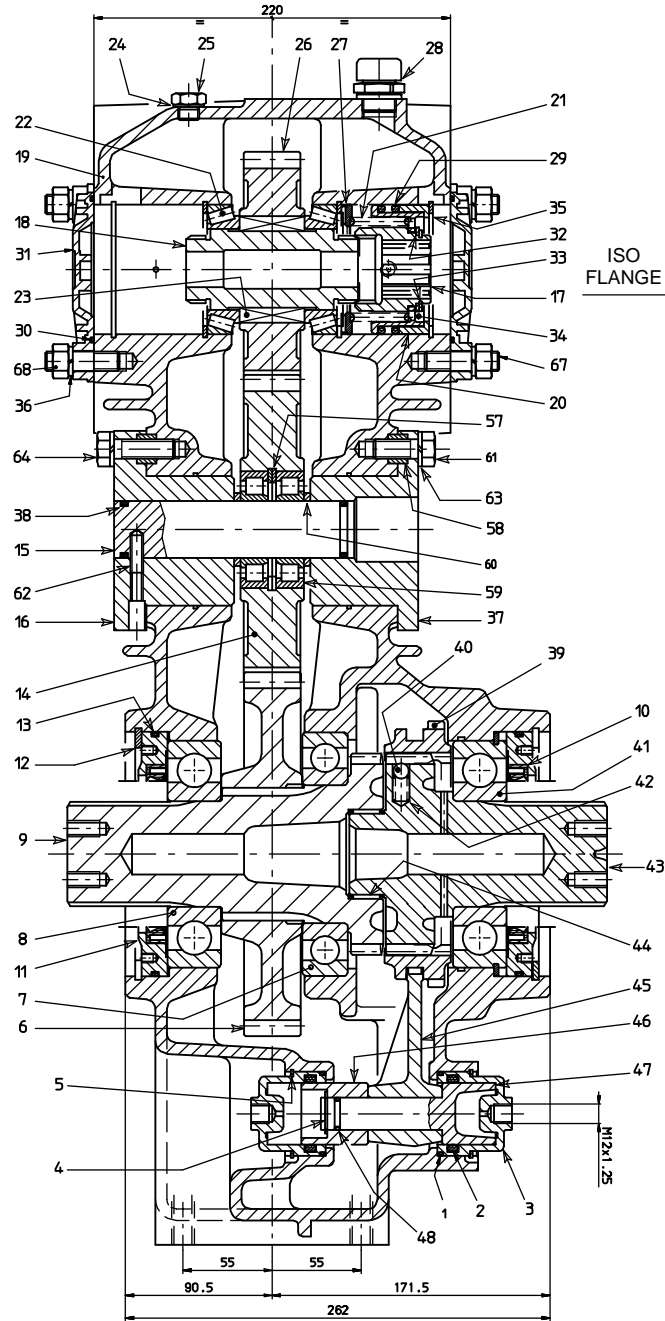

SECTION A-A

FRONT OF VEHICLE

VERSION 3.2.90.6.

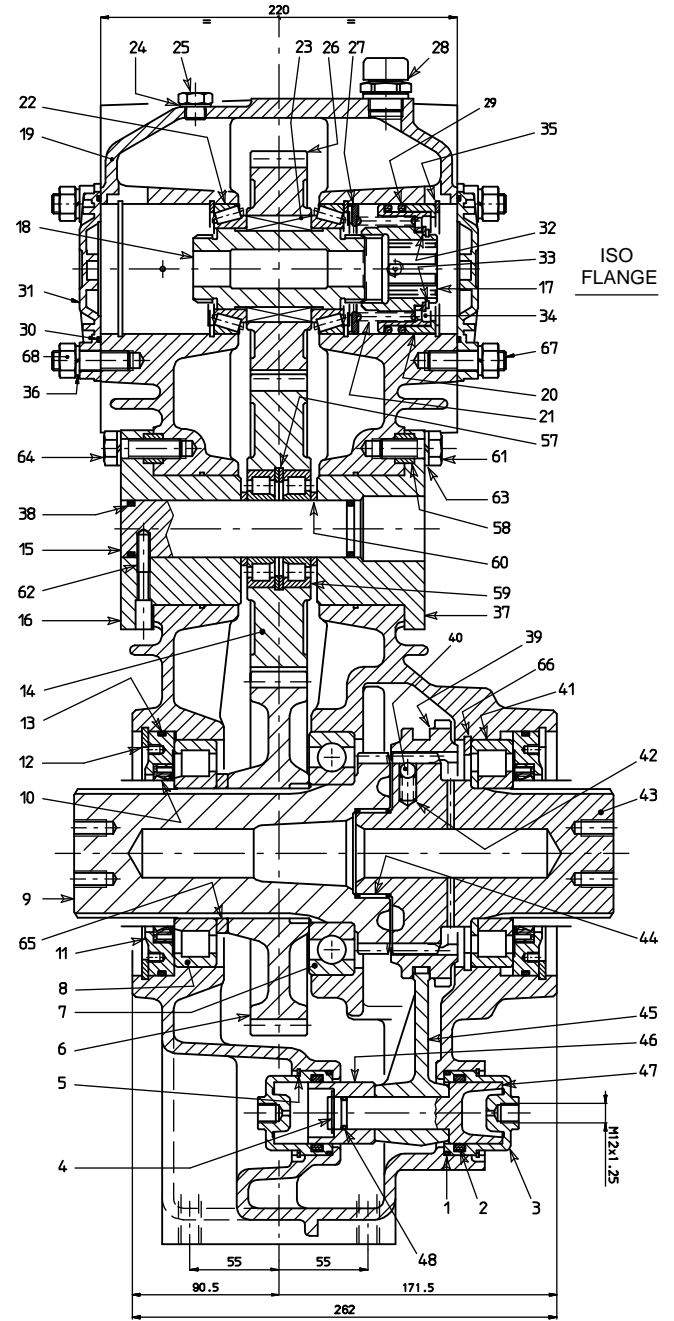

SECTION A-A

FRONT OF VEHICLE

REF.	CODE	DESCRIPTION	QT.	REF.	CODE	DESCRIPTION	QT.
1	0.08.02.138.00	O-Ring OR 3187 Viton	2	34	1.21.02.025.00	Piston	1
2	0.08.02.137.00	O-Ring OR 6150 Viton	2	35	0.07.02.012.00	Circlip 80i UNI 7437	3
3	1.08.01.001.00	Cylinder 218B/5	2	36	0.04.08.002.00	Lockwasher 12,5 DIN 7980	8
4	0.07.01.022.00	Circlip 20e UNI 7435	1	37	1.25.03.014.00	Shaft support	1
5	0.07.05.002.00	Circlip SB52	2	38	0.08.02.142.00	O-Ring OR 4112 Viton	2
6	1.11.03.107.00	Gear 50 T (P.T.O. 3.2.90.5)	1	39	1.17.02.080.00	Splined sleeve	1
	1.11.03.109.00	Gear 50 T (P.T.O. 3.2.90.6)		40	0.11.01.002.00	Ball 3/8"	3
7	0.10.01.042.00	Bearing 6217	1		0.10.01.041.00	Bearing 6313NR (P.T.O. 3.2.90.5)	
8	0.10.01.040.00	Bearing 6313 (P.T.O. 3.2.90.5)	1	41	0.10.03.022.00	Bearing NUP 216 (P.T.O. 3.2.90.6)	1
	0.10.03.021.00	Bearing NJ 216 (P.T.O. 3.2.90.6)		42	1.28.01.006.00	Coil spring mod.15	3
9	1.13.01.151.00	Shaft (P.T.O. 3.2.90.5)	1		1.13.01.152.00	Shaft (P.T.O. 3.2.90.5)	
	1.13.01.161.00	Shaft (P.T.O. 3.2.90.6)		43	1.13.01.162.00	Shaft (P.T.O. 3.2.90.6)	1
10	0.08.01.091.00	Seal 90x110x12 Viton	2	44	0.10.06.017.00	Needle cage K50x55x20H	1
11	1.27.02.122.00	Ring	2	45	1.22.01.044.00	Fork	1
12	0.07.02.046.00	Circlip 150i UNI 7437	2	46	1.21.02.038.00	Piston	1
13	0.08.02.140.00	O-Ring OR 4562 Viton	2	47	1.21.01.030.00	Piston	1
14	1.11.01.148.00	Gear 42 T	1	48	0.08.02.136.00	O-Ring OR 119 Viton	1
15	1.14.01.020.00	Shaft 800A/4	1	49	0.12.01.024.00	Plug G1/2"	1
16	1.25.03.013.00	Shaft support	1	50	0.04.01.039.00	Washer 26x20x1	1
17	1.17.02.071.00	Splined sleeve	1	51	0.12.01.002.00	Plug FIAT 1/43262/11	1
18	1.13.02.040.00	Shaft	1	52	0.01.01.076.00	Capscrew TE with flange M8x20 DIN 6921	6
19	1.01.05.014.00	Housing	1	53	1.24.01.094.00	Cover	1
20	1.27.02.079.00	Ring	1	54	0.12.01.049.00	Plug 18x1,5 FIAT 1/43236/11	1
21	1.28.01.075.00	Coil spring	1	55	0.12.01.065.00	Plug 22x1,5 FIAT 1/43244/11	1
22	0.10.05.027.00	Bearing 32010X	2	56	0.12.01.059.00	Plug U-908G1/8	2
23	0.06.01.018.00	Key 14x9x40 UNI 6604 - type "B"	2	57	0.07.02.015.00	Circlip 72i UNI 7437	2
24	0.04.01.077.00	Washer 13,5x19x1,5	1	58	0.99.00.264.00	Bush 12x18x12 DIN 179	4
25	1.30.03.029.00	Plug G1/4"	1	59	0.10.03.006.00	Bearing NJ 207	2
26	1.11.10.118.00	Gear 32 T	1	60	1.26.01.020.00	Spacer AS23/3	2
27	1.26.01.132.00	Ring	1	61	0.01.01.010.00	Capscrew TE M12x30 UNI 5739 CL RES 8.8	4
28	0.12.01.115.00	Filler-breather G1/2"	1	62	0.01.05.002.00	Capscrew STEI M8x25 UNI 5927 CL RES 45h	1
29	0.08.02.119.00	O-Ring OR 6275 Viton	2	63	0.04.02.004.00	Lockwasher 13 UNI 1751	8
30	0.08.02.163.00	O-Ring OR 38,8x2,62 DIN 3770 Viton	2	64	0.01.01.005.00	Capscrew TE M12x40 UNI 5739 CL RES 8.8	4
31	1.24.01.110.00	Cover	2	65	1.26.01.122.00	Spacer (P.T.O. 3.2.90.6)	1
32	1.26.01.085.00	Spacer	1	66	0.07.02.047.00	Circlip 140i UNI 7437 (P.T.O. 3.2.90.6)	1
33	0.07.01.016.00	Circlip 42e UNI 7435	1	67	0.02.02.031.00	Stud M12x30 UNI 5911	8
				68	0.03.01.019.00	Hex nut M12 ch. 17	8

ON REQUEST:

**DOUBLE-ACTING AIR CONTROL TO CONNECT/DISCONNECT MAIN DRIVE
CODE 0.00.04.023.00**

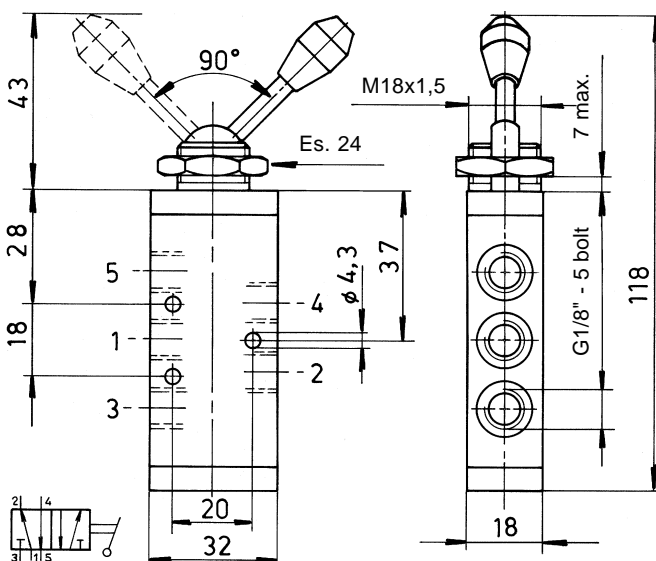

SPECIFICATIONS

Fluid:	Air, filtered and oiled
Operating pressure:	10 Bar max.
Operating temperature:	from -5°C to +70°C

ON REQUEST: MOUNTING BRACKET KIT CODE 2.99.107.0000

Mounting kits are available for easy installation of the 3.2.90.5 and 3.2.90.6 Split-Shaft Units in the truck chassis.

The kit includes brackets and elastic suspension elements.

